

Flat

5905

Design By Ichiro Iwasaki

Flat is a ceiling lamp composed of horizontal discs at various heights that create planes of reflected light. The Flat ceiling light has a strong graphic quality, combining structure and functionality.

VIBIA

Model Sheet

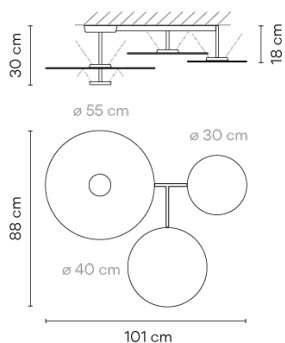

Finish

- 71 White, Green L1, Off-White
NCS S 0300-N, NCS S 4005-G80Y, NCS S 1000-N
- 10 White
NCS S 0300-N

LED temperature color 2700 K

Dimming DALI 1-10V Push

Installation type Surface Canopy





Materials

- Ceiling rose: Steel
- Reflector: Aluminum
- Body: Steel
- Head: Aluminium

Light source 4 x LED PLATE 13,5W 700mA
E

LED CRI>90 6960 lm 128.88
2700 K

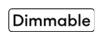
Driver CC - Constant Current 700
220~240 V 50/60 HZ

Application Ceiling Lamps

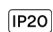
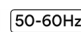
Packaging

- 1 Box
- 0.727 m x 0.727 m x 0.32 m
- Gross weight 25.8
- Net weight 15.38
- Vol. 0.1691

Lighting effect

General Lighting

Lamp that emits an upward or backward beam that is reflected by the ceiling or wall.

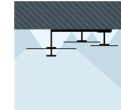

Photometric Data

Efficiency 68.21 lm/W
Coordinate System CG
Total Flux 3015.66 lm
Maximum Value 826.00 cd

Other Applications

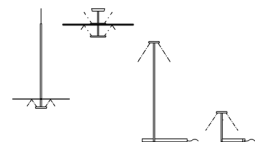

All of our products come with a five-year warranty.
Check our legal terms at www.vibia.com/warranty

Vibia Lighting, S.L.U.

Office / Oficina
Progrés 4-6. 08850 Gavà. Barcelona, Spain.

International T +34 934 796 971
Spain / Portugal T +34 934 796 970

customer.service@vibia.com
vibia.com