

TECHNICAL SPECIFICATIONS

MSAKXL

# Sako

## Table XL

This new collection of tables is born from the search for pure, soft, and gentle forms to enhance any interior. The woven material that envelops the pedestal gives the piece a feeling of warmth and great versatility. It is a functional piece with endless possibilities.

DESIGNED BY AGV Estudio



**ondarreta**

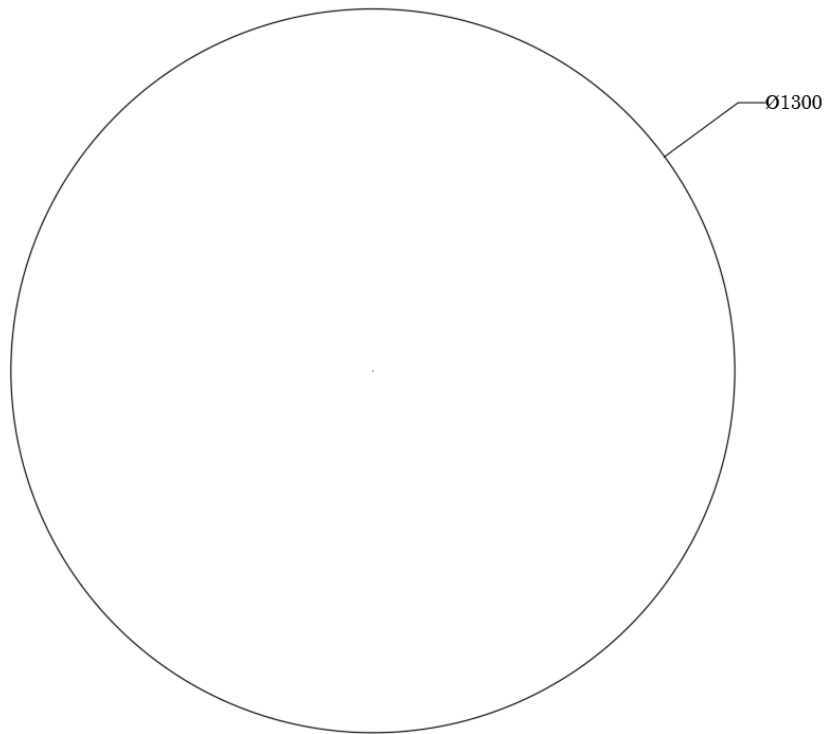
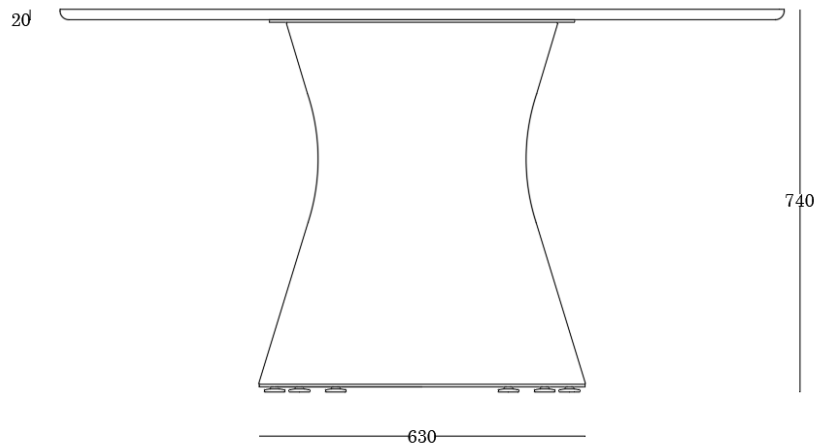

DIMENSIONS (without tabletop)

63 cm x 63 cm x 75,5 cm  
[width x depth x height]

WEIGHT (without tabletop)

39,7 kg

“FLATPACK” Packaging

**Package 1** (Base + Upholstery + Column): 110cm x 72cm x 12cm

**Package 2**

Tabletop Ø120: 125cm x 125cm x 15cm

Tabletop Ø130: 135cm x 135cm x 15cm

Tabletop Ø140: 145cm x 145cm x 15cm

CERTIFICATION

Wood with FSC forest certification

ACCESSORIES

Electrification mini

Electrification USB

Upholstered cover replacement

ORIGIN

100% Made in Europe

DESIGN

AGV Estudio



## **COMPONENTS**

### **COLUMN**

#### **Material**

3 cylindrical tubes with a diameter of 70 mm and a thickness of 2 mm in cold-rolled pickled steel grade St-37

Tensile strength: 340-470 N/mm<sup>2</sup>;

Yield strength: > 235

N/mm<sup>2</sup>; Elongation: > 25%,

Surface hardness: > 110 HB.

### **BASE**

#### **Material**

Round sheet metal in S-275 JR quality steel, 8 mm thick and 630 mm in diameter

#### **Finish**

Epoxy Colour.

### **TABLETOP SUPPORT**

#### **Material**

Round sheet metal in S-275 JR quality steel, 5 mm thick and 590 mm in diameter.

#### **Finish**

Epoxy Colour.

### **TABLETOP**

#### **Oak + MDF**

Natural oak veneer glued and pressed under strong pressure and heat onto a 20mm thick engineered wood support. CNC machined with beveled edge.

#### **Laminate + Birch Plywood**

High-pressure laminate (HPL) glued and pressed at high temperature onto 20mm thick birch plywood. CNC machined with beveled edge.

#### **Arpa Fénix + Birch Plywood**

Arpa Fénix pressed at high temperature onto 20mm thick birch plywood. CNC machined with beveled edge. Phoenix Harp is an opaque, fingerprint-resistant, and nanotechnological material capable of recovering from micro-surface scratches.

#### **Finish**

According to the colors in the finishes box

#### **Dimensions**

Maximum tabletop size: Ø140 cm



## **COVER**

### **Material**

Textile cover specially designed to provide a very special geometry and design.

### **Finish**

Fabric category B with elastic characteristics that give it the ability to adapt to the very special geometry of this product.

Contour Fabric: Colors according to Ondarreta catalogue

Moby Fabric: Colors according to Ondarreta catalogue

Moss Fabric: Colors according to Ondarreta catalogue

## **LEVELING GLIDES**

### **Material**

Polypropylene levelling glide with 22mm steel thread.

## **STEEL FINISHES**

### **EPOXYS**

Powder coating formulated with polyester resins with good mechanical and chemical properties, maximum outdoor resistance, and free of harmful compounds (TGIC). Applied electrostatically and cured in an oven at 200°C.

### **Technical Specifications:**

Film thickness (ISO 2360): between 60 and 90 µm.

Grid adherence (ISO 2409): Quality: 0 (maximum requirement)