

INSTRUCCIONES DE MONTAJE

ARTÍCULO 12652

i3

iluminación 3

ATENCIÓN: Recomendamos que utilice los balancines suministrados en la instalación de este lámpara.

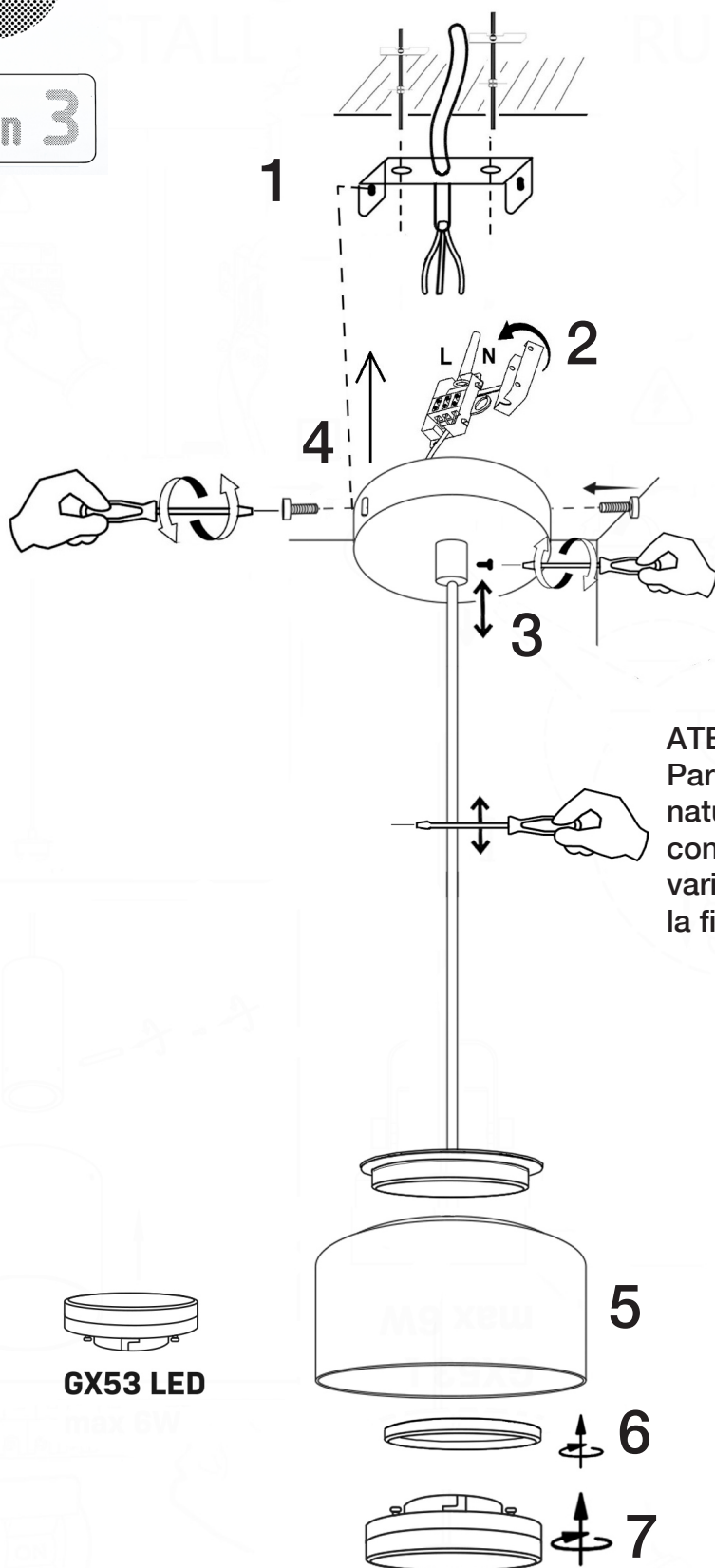

ASSEMBLING INSTRUCTIONS

ITEM 12652



iluminación 3

ATTENTION: We recommend to use included special screws when installing this lamp.

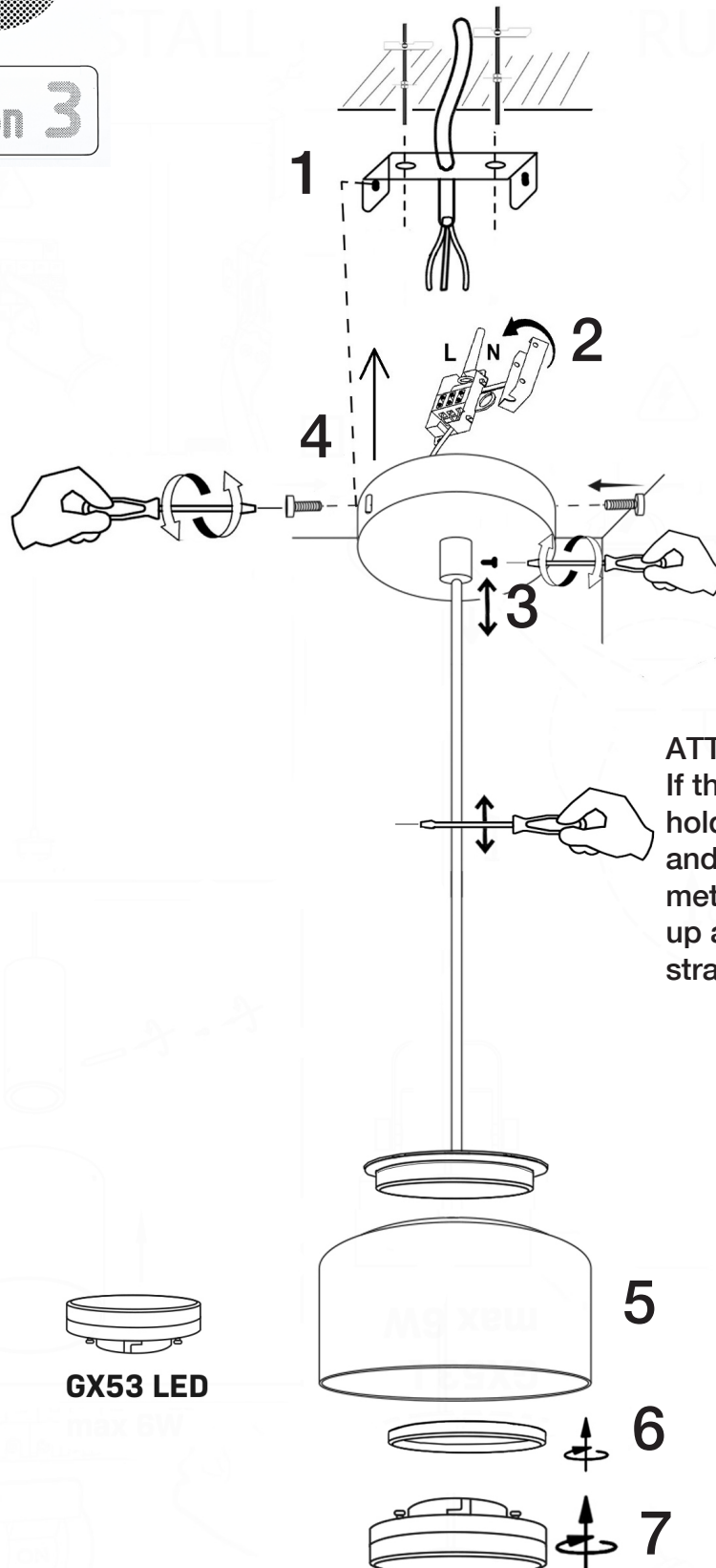

ATTENTION:

If the cable is twisted, please hold the bottom of the cable, and use a screwdriver or a metal rod to stroke the cable up and down to keep it straight.