



BRAND  
COLLECTION



VISO LIGHTING

We transform everyday interactions with the environment and uplift senses with the power of light.

 <p><b>PABLO</b>   PG. 12</p>	 <p><b>WANDERING STAR</b>   PG. 24</p>	 <p><b>NANCIE</b>   PG. 10</p>	 <p><b>ALO</b>   PG. 22</p>	 <p><b>FRED</b>   PG. 8</p>	 <p><b>MAGGIE</b>   PG. 20</p>	 <p><b>SIGNAL</b>   PG. 6</p>	 <p><b>RINGS</b>   PG. 18</p>	 <p><b>LINEA</b>   PG. 4</p>	 <p><b>BRIGGS</b>   PG. 16</p>	 <p><b>HITO</b>   PG. 2</p>	 <p><b>CHESTNUT</b>   PG. 14</p>
 <p><b>ILU</b>   PG. 34</p>	 <p><b>GEMMA</b>   PG. 32</p>	 <p><b>CUBIE</b>   PG. 30</p>	 <p><b>GIA</b>   PG. 28</p>	 <p><b>BOLLO</b>   PG. 38</p>	 <p><b>GIA ROUND</b>   PG. 26</p>	 <p><b>THIN LED</b>   PG. 36</p>	 <p><b>FORT KNOX</b>   PG. 42</p>	 <p><b>GLOBO</b>   PG. 40</p>			

# HITO

Designer | VISO Design Studio



WHISKY

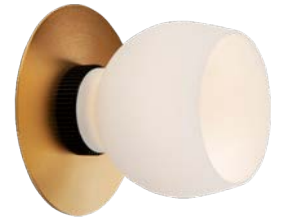

WINE



MARTINI

The sconces from our HITO Collection quenches your thirst for design. Each fixture is inspired by the glassware profile for a particular drink: Martinis, Old Fashioned, High Balls, Brandy/ Cognac Bowls, and Wine.

An LED bulb embedded in a black anodized aluminum base gives off a soft glow through the glass shade. Its small footprint makes this an easy and elegant sconce to include in any environment. Cheers to that!

- Available in two finishes
- Integrated LED 3000K
- Wall or ceiling mounted
- Average Rated Life: 50,000 hours
- Triac/ELV dimming

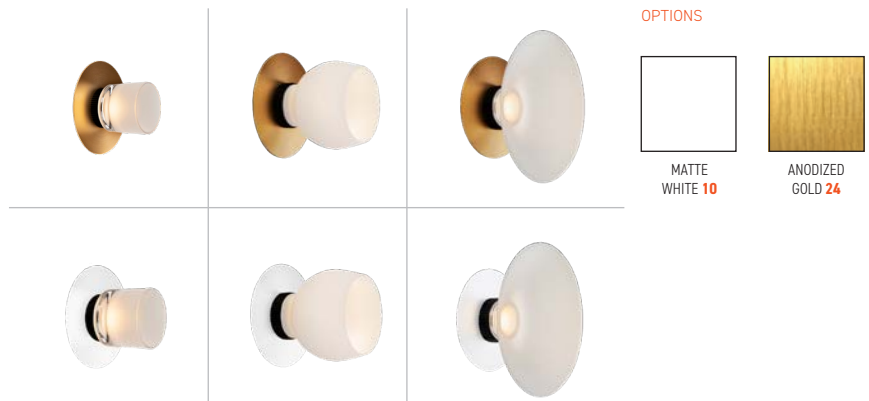

## OPTIONS



MATTE  
WHITE 10



ANODIZED  
GOLD 24

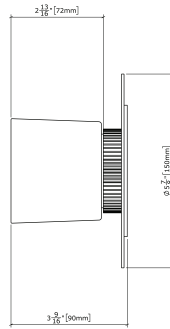
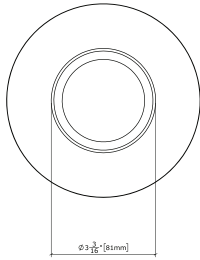

Model Hito  
 Size 81mm  
 Ref. # SM.07.647\_\_\_.01  
 (metal.whiskyglass)  
 Lamping 6W integrated AC LED module  
 3000K, RA80+, 440lm  
 Triac/ELV dimmable  
 Average Rated Life: 50,000 hours

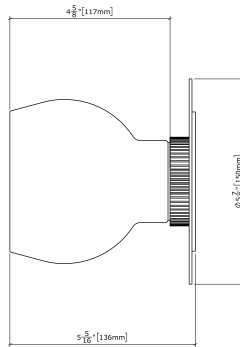
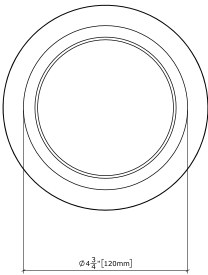

Model Hito Sconce  
 Size 120mm  
 Ref. # SM.07.647\_\_\_.02  
 (metal.wineglass)  
 Lamping 6W integrated AC LED module  
 3000K, RA80+, 440lm  
 Triac/ELV dimmable  
 Average Rated Life: 50,000 hours

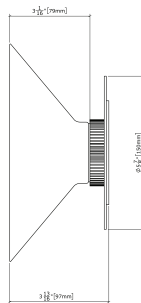
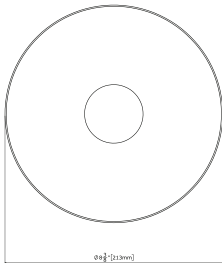

Model Hito Sconce  
 Size 213mm  
 Ref. # SM.07.647\_\_\_.03  
 (metal.martiniglass)  
 Lamping 6W integrated AC LED module  
 3000K, RA80+, 440lm  
 Triac/ELV dimmable  
 Average Rated Life: 50,000 hours



# LINEA

Designer | VISO Design Studio



Clean, distinctive lines characterize the Linea Glass Collection. Available in three different sizes, this modern wall sconce features a linear fluted glass shade that diffuses the light in a calming manner while creating linear array effect.

The elegant bend metal spine is available in Aluminum or Brass, allowing for customization to your specific interior design. The sconce is lit with a linear LED lamp and is compatible with a variety of dimming platforms. A simple and elegant surface mounted fixture perfect for countless residential and hospitality applications.

- Available in two finishes
- Integrated LED 3000K
- Horizontal or vertical installation models
- Average Rated Life: 40,000 - 50,000 hours
- Triac/ELV dimming



## OPTIONS



POLISHED  
CHROME 12



ANODIZED  
GOLD 24

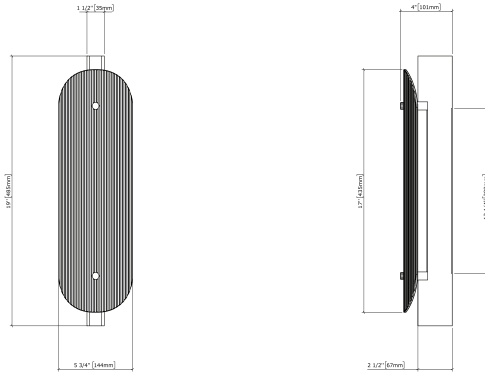

Model Linea Sconce  
 Size 485mm  
 Ref. # SM.09.233.\_ \_  
 Lamping 15W integrated AC LED module  
 3000K, CRI 90, 1350lm  
 Triac/ELV dimmable  
 Average Rated Life:  
 40,000 - 50,000 hours

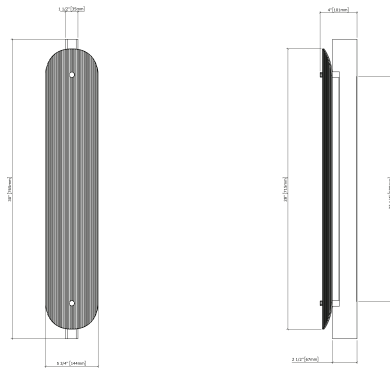

Model Linea Sconce  
 Size 765mm  
 Ref. # MM.09.233.\_ \_  
 Lamping 30W integrated AC LED module  
 3000K, CRI 90, 2700lm  
 Triac/ELV dimmable  
 Average Rated Life:  
 40,000 - 50,000 hours

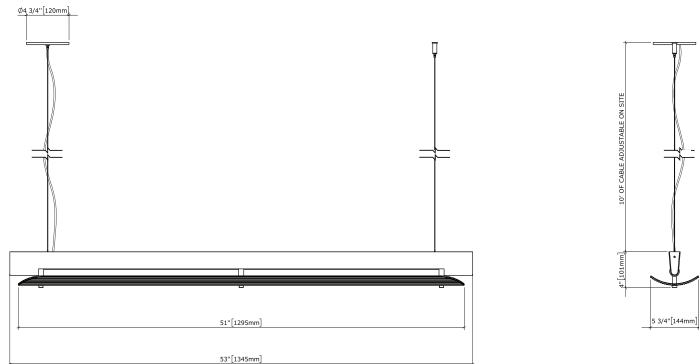

Model Linea Sconce  
 Size 1345mm  
 Ref. # GM.07.233.\_ \_  
 Lamping 60W integrated AC LED module  
 3000K, CRI 90, 5400lm  
 Triac/ELV dimmable  
 Average Rated Life:  
 40,000 - 50,000 hours

	SM	MM	GM
Lbs	3	5	6
Kg	1.4	2.3	2.7



# SIGNAL

Designer | VISO Design Studio



The Signal collection features fixtures with a Fresnel-inspired lens made from borosilicate glass, similar to those found in lighthouses and searchlights.

This collection is a beautiful expression of simple design, highlighted by the succession of concentric rings that draws you in and soothes you with its minimalist design.

Two different sized housing, available in Glossy Black and Brushed Brass, provide different concentration and angles of light. This piece lights a distinctive path in any application: indoor or outdoor.

- Available in two finishes
- Integrated LED 3000K
- Wall or ceiling mounted
- Indoor/Outdoor installation
- Average Rated Life: 50,000 hours
- Triac/ELV dimming

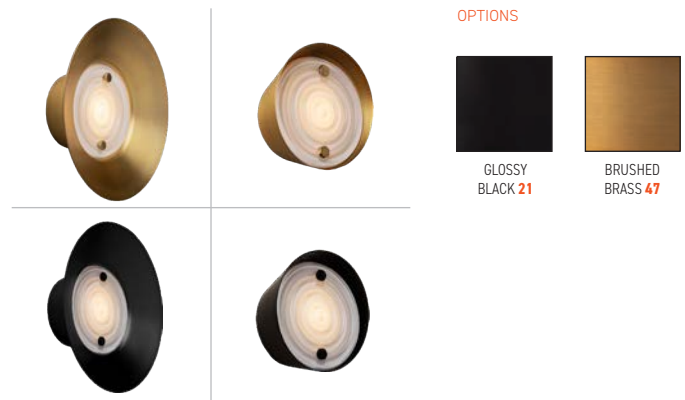



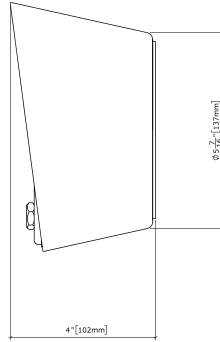
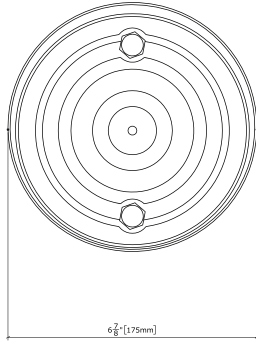

Model	Signal
Size	175mm
Ref. #	SM.09.820._._
Lamping	9W integrated AC LED module 3000K, RA80+, 870lm Triac/ELV dimmable Average Rated Life: 50,000 hours
	⏚

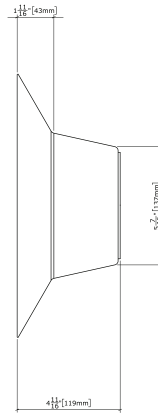
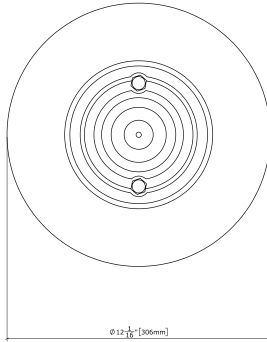

Model	Signal
Size	306mm
Ref. #	MM.09.820._._
Lamping	9W integrated AC LED module 3000K, RA80+, 870lm Triac/ELV dimmable Average Rated Life: 50,000 hours
	⏚

	SM	MM
Lbs	2	3
Kg	0.9	1.3



# FRED

Designer | VISO Design Studio

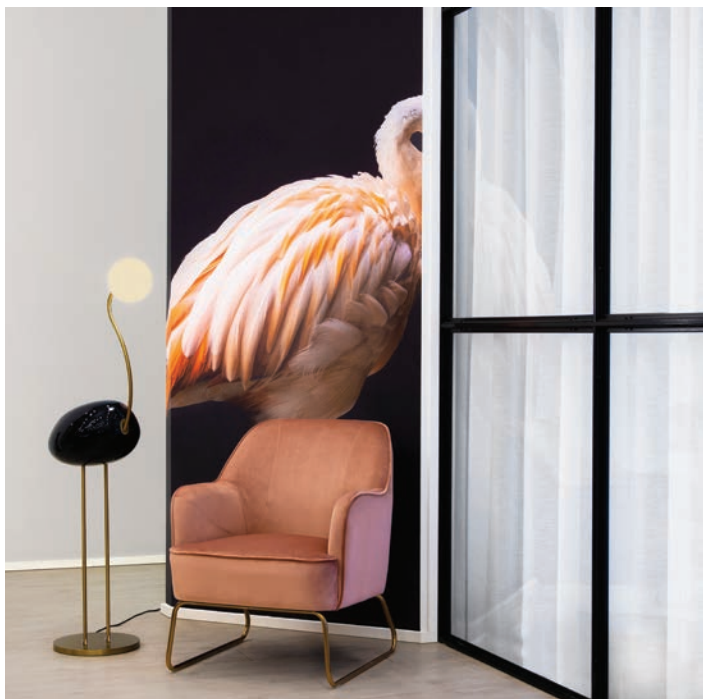

Fred is bold, elegant, and majestic - poised to make a statement no matter where he goes. Elevated by two brushed metal legs and a metal base, this floor lamp features an opal glass diffuser that sits on a curved neck extending from a high-gloss painted resin body. Fred radiates impeccable style and effortlessly assumes the center of attention in any space.

- Brushed metal neck, legs and base
- Opal glass diffuser
- High gloss painted resin body in variable colours
- Other metal finishes available
- Dimmable LED 2700K



## OPTIONS



MIDNIGHT  
BLUE 25



BRUSHED  
BRASS 45



HOT VANILLA  
10



PAINTED BLACK  
21

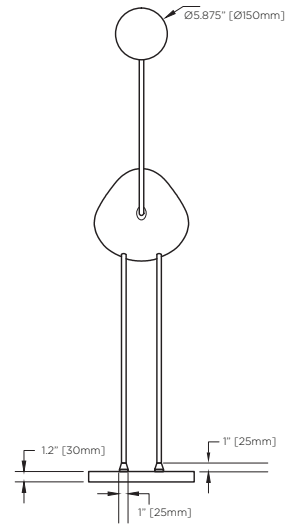
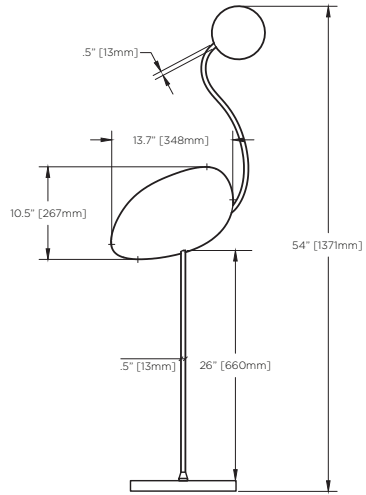

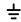
Model **Fred**  
 Size **1371**  
 Ref. # **MM.08.720\_ \_ \_ \_**  
 Lamp **1x3W G9 LED**  
**LED** **2700K**  
  



# NANCIE

Designer | VISO Design Studio



Nancie is distinct, exquisite and magnetic - her presence is sure to light up any room. Nancie's unique shape is complemented by her high-gloss painted resin body and elegant brushed metal details on her neck and legs. Nancie is unconventional and absolutely irresistible.

- Brushed metal neck, legs and base
- Opal glass diffuser
- High gloss painted resin body in variable colours
- Other metal finishes available
- Terrazzo stone base available
- Dimmable LED 2700K

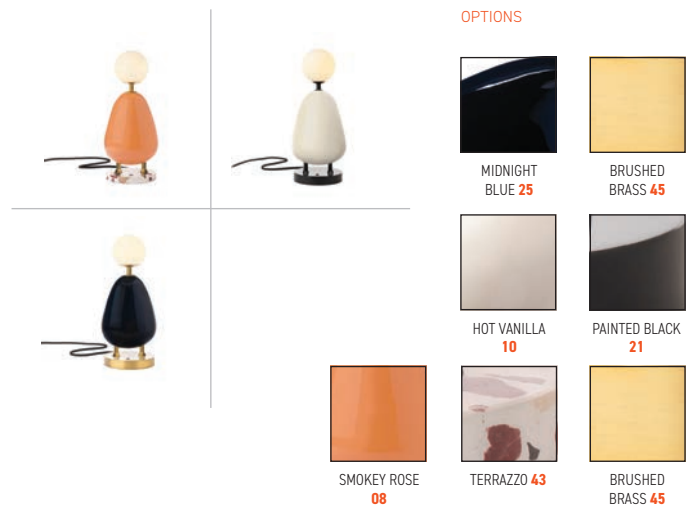

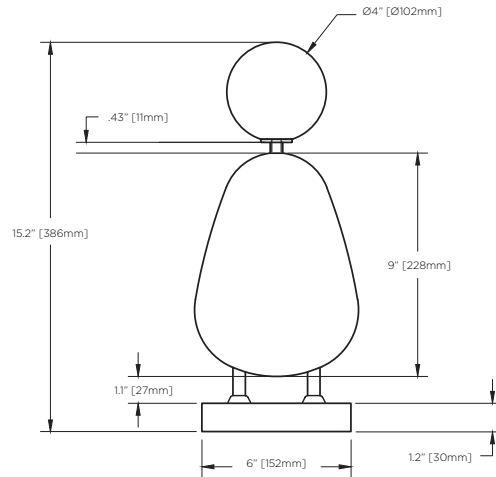

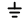
Model	<b>Nancie</b>
Size	386
Ref. #	SM.02.721_ _ _ _ _
Lamp	1x3W G9 LED
	2700K
	
	



# PABLO

Designer | VISO Design Studio



Pablo is calm, chic and enigmatic – he invites balance and introspection, bringing everything back into focus. He is light-hearted yet grounded and empowers every space with understated elegance. The curved neck reinforces his dynamism enhanced by a frosted opal glass diffuser, a high-gloss painted resin body and metal details. With Pablo, there is always more than meets the eye.

- Brushed metal neck, legs and base
- Opal glass diffuser
- High gloss painted resin body in variable colours
- Other metal finishes available
- Dimmable LED 2700K



## OPTIONS



MIDNIGHT  
BLUE 25



BRUSHED  
BRASS 45



HOT VANILLA  
10



PAINTED BLACK  
21

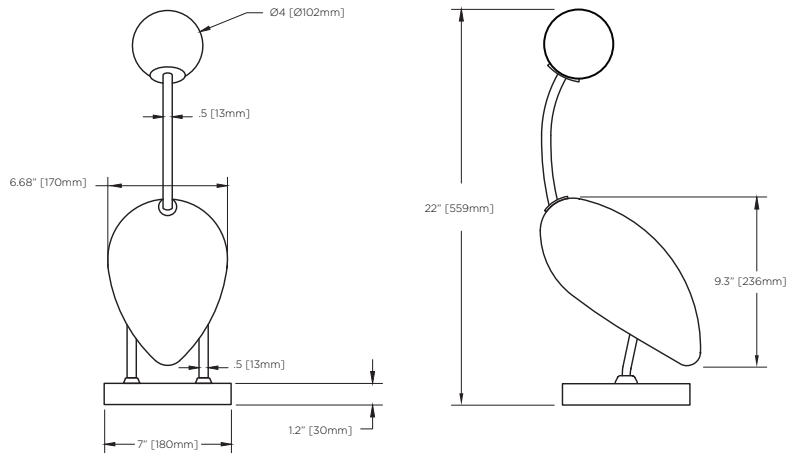

Model	<b>Pablo</b>
Size	559
Ref. #	SM.02.721_ _ _ _
Lamp	1x3W G9 LED
	2700K
	⚡



# CHESTNUT

Designer | VISO Design Studio



Spun metal light fixture with champagne finish

Fixture can be installed on the ceiling, as a wall sconce or used as decorative art

Available in four standard clusters: four, six, nine and eleven.

Connected to individual power sources or to a single source with the purchase of a connecting kit\*

The angle of each plate can be articulated individually

Custom clusters available

Dimming options available

Standard 0-10V dimming

Custom finishes available

Integrated LED



FINISHES

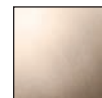

CHAMPAGNE 28

\*SINGLE POWER SOURCE CONNECTING KIT OPTION AVAILABLE.

**CODES**

4MM.250.KIT

6MM.250.KIT

9MM.250.KIT

11MM.250.KIT



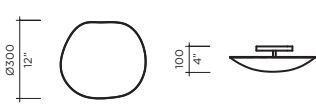

Model **Chestnut**  
 Size **300**  
 Ref. # **SM.09.250.\_ \_**  
 Lamping **1x12W LED**  
**3000K**

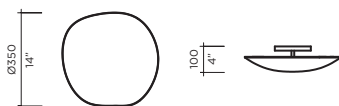

Model **Chestnut**  
 Size **350**  
 Ref. # **MM.09.250.\_ \_**  
 Lamping **1x12W LED**  
**3000K**

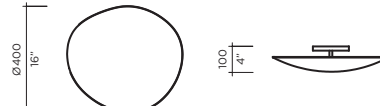

Model **Chestnut**  
 Size **400**  
 Ref. # **GM.09.250.\_ \_**  
 Lamping **1x12W LED**  
**3000K**

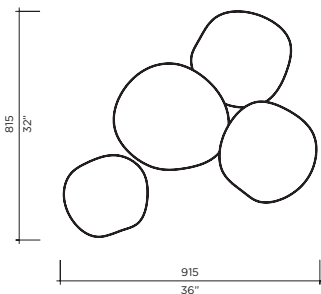

Model **Chestnut**  
 Size **300, 350, 400**  
 Ref. # **4MM.09.250.\_ \_**  
 Connecting Kit **4MM.250.KIT**  
 Lamping **4x12W LED**  
**3000K**

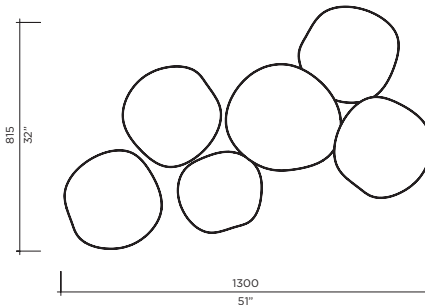

Model **Chestnut**  
 Size **300, 350, 400**  
 Ref. # **6MM.09.250.\_ \_**  
 Connecting Kit **6MM.250.KIT**  
 Lamping **6x12W LED**  
**3000K**

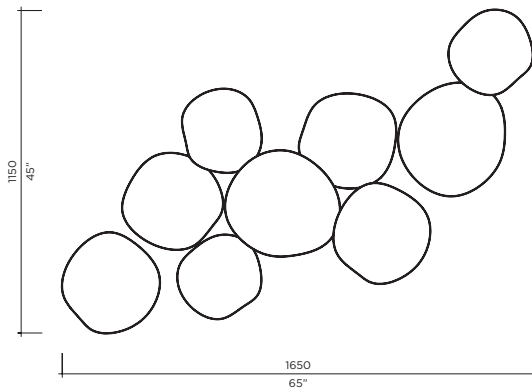

Model **Chestnut**  
 Size **300, 350, 400**  
 Ref. # **9MM.09.250.\_ \_**  
 Connecting Kit **9MM.250.KIT**  
 Lamping **9x12W LED**  
**3000K**

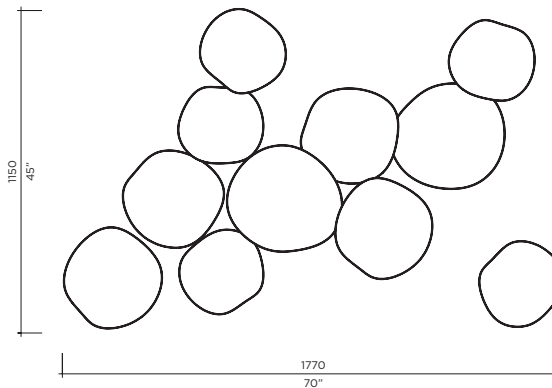

Model **Chestnut**  
 Size **300, 350, 400**  
 Ref. # **11MM.09.250.\_ \_**  
 Connecting Kit **11MM.250.KIT**  
 Lamping **11x12W LED**  
**3000K**

CHESTNUT SPECS

	SM	MM	GM
Lbs	2	3	3
Kg	.9	1.4	1.4



# BRIGGS

Designer | VISO Design Studio



Plated metal finish in champagne  
Frosted white acrylic diffuser  
Four unique geometric sizes are available  
Available in two standard clusters with four or seven pendants  
Custom clusters are available  
Dimming options are available  
Custom finishes are available  
LED



FINISHES



CHAMPAGNE 28

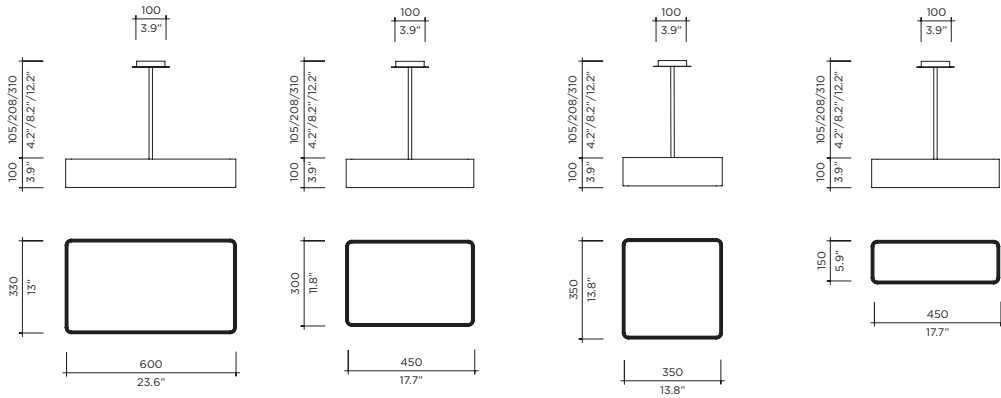

Model **Briggs Suspension**  
 Size 600  
 Ref. # GM.07188\_\_  
 Bulb 1x25W LED  
 3000K

Model **Briggs Suspension**  
 Size 450  
 Ref. # MM.07188\_\_  
 Bulb 1x18W LED  
 3000K

Model **Briggs Suspension**  
 Size 350  
 Ref. # SM.07188\_\_  
 Bulb 1x16W LED  
 3000K

Model **Briggs Suspension**  
 Size 150  
 Ref. # BM.07188\_\_  
 Bulb 1x9W LED)  
 3000K

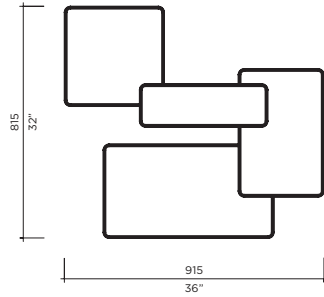

Model **Briggs Suspension**  
 Size 150, 350, 450, 600  
 Ref. # 4MM.07188\_\_  
 Bulb 68W LED)  
 3000K

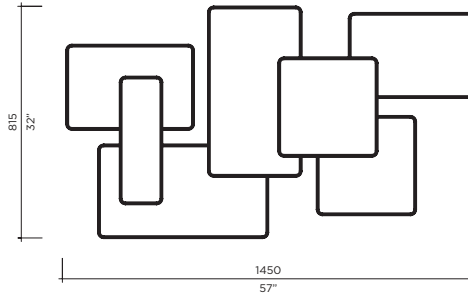

Model **Briggs Suspension**  
 Size 150, 350, 450, 600  
 Ref. # 7MM.07188\_\_  
 Bulb 127W LED  
 3000K

	<b>BM</b>	<b>SM</b>	<b>MM</b>	<b>GM</b>
	Lbs 10.5	13.3	16.3	21.6
	Kg 4.8	6	7.4	9.8

# THE RING

Designer | VISO Design Studio



Plated steel body is available in multiple finishes

Custom sizes and colours are available

Custom canopies are available\*

Dimming options are available

Diffuser is included

LED

\*Custom canopies are available for orders above \$5K only.

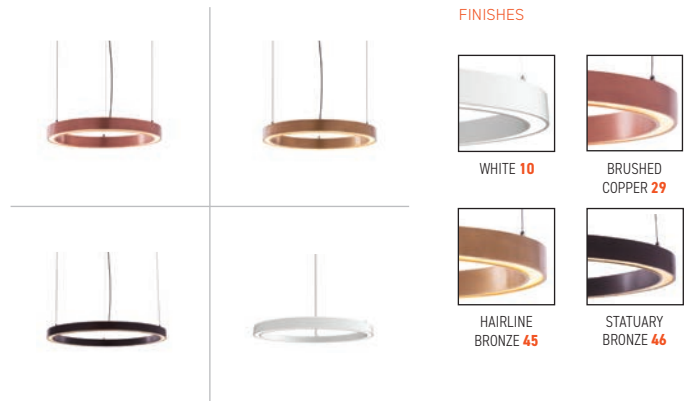

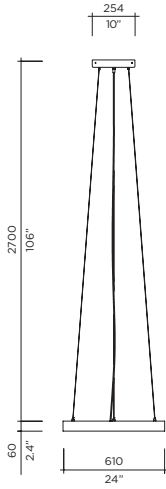

Model **Ring Suspension**  
 Size 610  
 Ref. # SM.07.500.\_.\_  
 Lamping 1 x 30W LED  
 3000K, 2400Lm

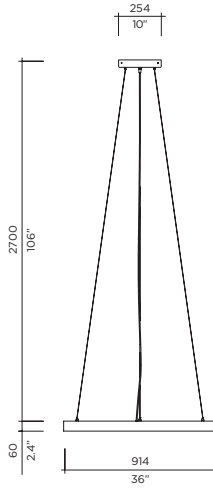

Model **Ring Suspension**  
 Size 914  
 Ref. # MM.07.500.\_.\_  
 Lamping 1 x 36w LED  
 3000K, 2880Lm

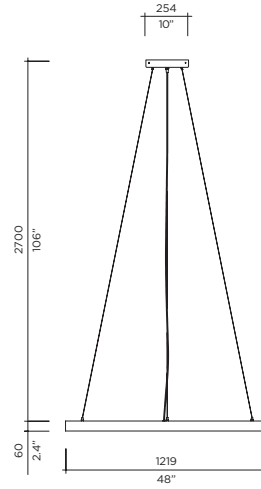

Model **Ring Suspension**  
 Size 1219  
 Ref. # GM.07.500.\_.\_  
 Lamping 1 x 48w LED  
 3000K, 3840Lm



	SM	MM	GM
Lbs	9	14	29
Kg	4	6.4	13.2



# MAGGIE

Designer | VISO Design Studio

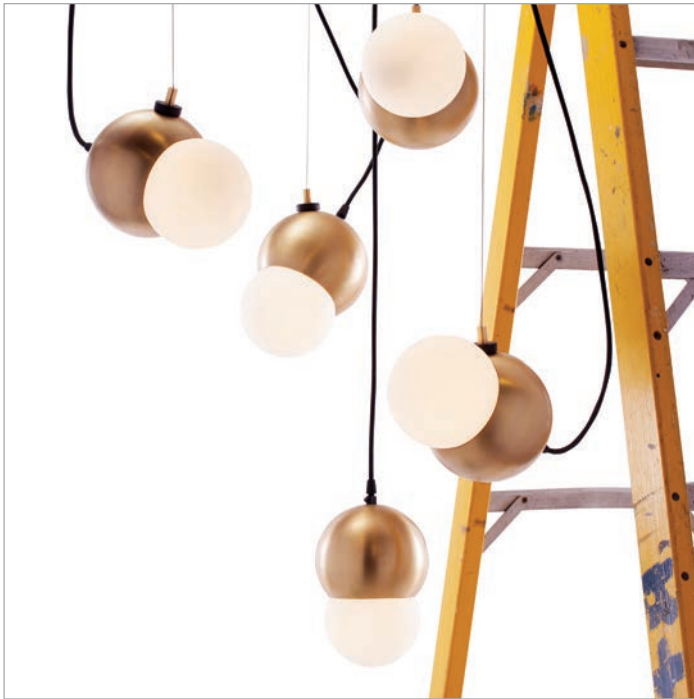

Two-tone suspension light

Spun steel globe with plated finish

White opal glass insert

Dynamic magnetic attachment doubles as support cable and design accessory that changes the fixture's orientation according to customers needs

Spun steel globe and canopy are available in various finishes

Custom clusters available

Includes black cloth cord

LED



## FINISHES



BRUSHED  
COPPER 29



HAIRLINE  
BRONZE 45



STATUARY  
BRONZE 46

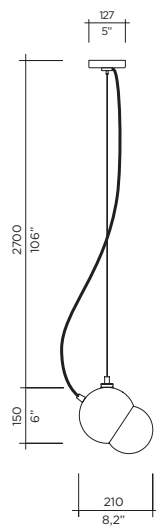

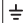
Model **The Maggie Suspension**  
 Size 210  
 Ref. # SM.07.301\_ \_ \_  
 Lamp 7W LED  
 3000K, 680Lm  
 Triac/ELV/0-10V Dimming Available  
 Dims from 100% - 15%  



 MM  
 Lbs 4  
 Kg 1.8



# ALO

Designer | VISO Design Studio



Frosted glass pendant with clear accents

Plated metal available in multiple proprietary finishes

Frosted glass acts as a diffuser

Custom clusters are available

Dimming options are available for clusters of 5 and up  
LED



## FINISHES

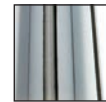

MIRRORED  
SILVER **12**



MIRRORED  
COPPER **22**



MIRRORED  
GOLD **24**



HAIRLINE  
BRONZE **45**



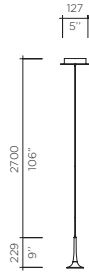

Model **Alo Suspension**  
 Size 152, 229  
 Ref. # SM.07.350\_\_  
 MM.07.350\_\_  
 Lamping 1 x 1W LED  
 3000K, 100Lm/ea.

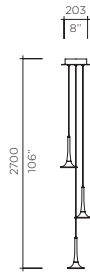

Model **Alo Suspension**  
 Size 152, 229  
 Ref. # 3SM.07.350\_\_  
 3MM.07.350\_\_  
 Lamping 3 x 1W LED  
 3000K, 100Lm/ea.

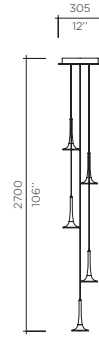

Model **Alo Suspension**  
 Size 152, 229  
 Ref. # 5SM.07.350\_\_  
 5MM.07.350\_\_  
 Lamping 5 x 1W LED  
 3000K, 100Lm/ea.

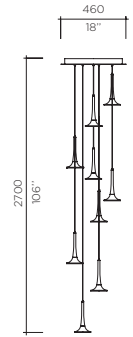

Model **Alo Suspension**  
 Size 152, 229  
 Ref. # 9SM.07.350\_\_  
 9MM.07.350\_\_  
 Lamping 9 x 1W LED  
 3000K, 100Lm/ea.

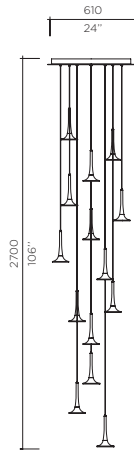

Model **Alo Suspension**  
 Size 152, 229  
 Ref. # 14SM.07.350\_\_  
 14MM.07.350\_\_  
 Lamping 14 x 1W LED  
 3000K, 100Lm/ea.

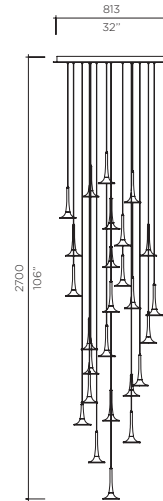

Model **Alo Suspension**  
 Size 152, 229  
 Ref. # 26SM.07.350\_\_  
 26MM.07.350\_\_  
 Lamping 26 x 1W LED  
 3000K, 100Lm/ea.

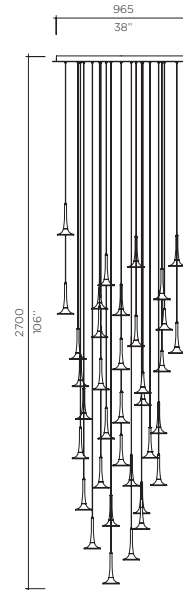

Model **Alo Suspension**  
 Size 152, 229  
 Ref. # 36SM.07.350\_\_  
 36SMM.07.350\_\_  
 Lamping 36 x 1W LED  
 3000K, 100Lm/ea.



# WANDERING STAR

Designer | VISO Design Studio



Dual-tone globe with solid European marble top and cast glass lens with diffuser on the inside

Metal plated details in hairline bronze finish

Includes silver coaxial cable

Custom clusters are available

LED



## OPTIONS

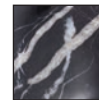

NERO MARBLE  
MARQUINA  
POLISHED **55**



CARRARA  
MARBLE WHITE  
POLISHED **50**



TRABERTINO  
BEIGE STONE  
MATTE **43**



CARRARA  
MARBLE WHITE  
MATTE **51**



INDIAN GREEN  
MARBLE  
POLISHED **56**

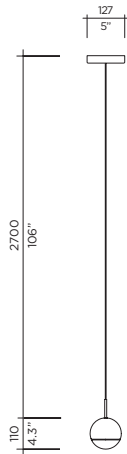

**Model** Wandering Star Suspension  
**Size** 110  
**Ref. #** SM.07.351.\_.\_  
**Lamping** 5.5W LED  
 3000K, 440Lm  
 Triac/ELV/0-10V Dimming Available  
 Dims from 100% - 15%  

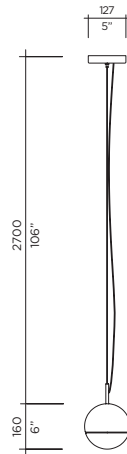

**Model** Wandering Star Suspension  
**Size** 160  
**Ref. #** MM.07.351.\_.\_  
**Lamping** 12W LED  
 3000K, 960Lm  
 Triac/ELV/0-10V Dimming Available  
 Dims from 100% - 15%  

	<b>SM</b>	<b>MM</b>
Lbs	3	10
Kg	1.4	4.5



# GIA ROUND

Designer | VISO Design Studio



Dazzling four faceted Asfour crystals  
Chrome plated frame  
Chrome metal canopy  
Custom designs and drops are available  
LED option is available

## OPTIONS

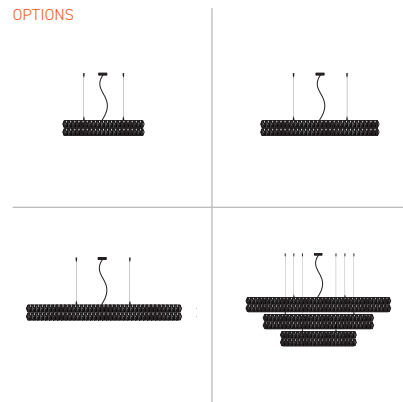

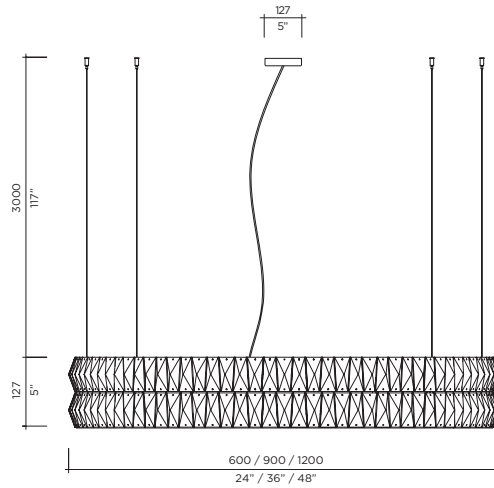

**Model** Gia Round Suspension  
**Size** 600, 900, 1200  
**Ref. #** SM.07.281  
 MM.07.281  
 GM.07.281  
**Lamp** G9 Bi-Pin Halogen (120V/220V)  
 6 x 25W (600)  
 10 x 25W (900)  
 12 x 25W (1200)  
 LED  
 6 x 25W equivalent  
 10 x 25W equivalent  
 12 x 25W equivalent  

	SM	MM	GM
Lbs	35	45	58
Kg	15.9	20.4	26.3



# GIA LINEAR

Designer | VISO Design Studio

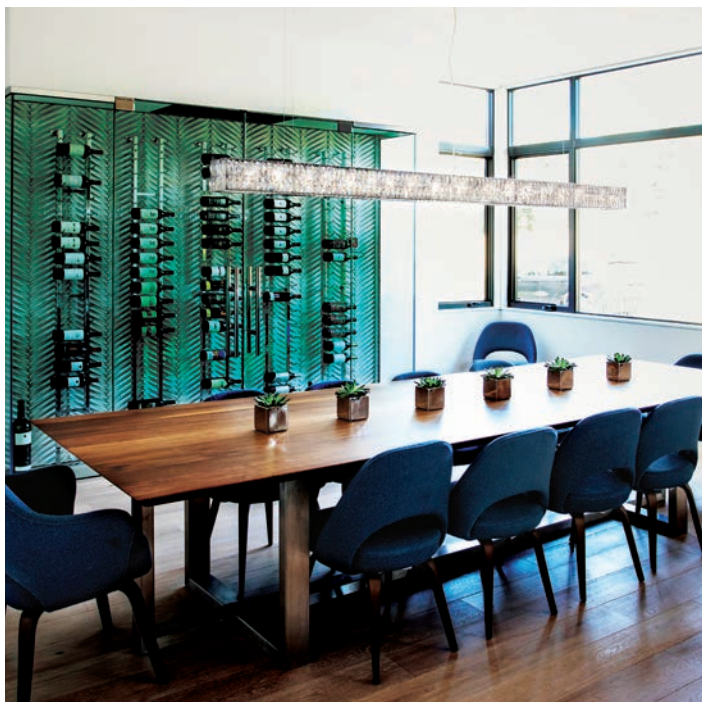

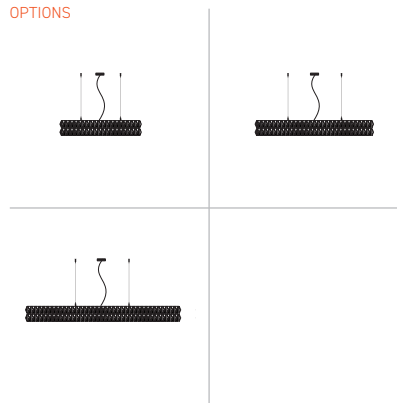

Dazzling four faceted Asfour crystals  
Chrome plated frame  
Chrome metal canopy  
Custom designs and drops are available  
LED option is available

## OPTIONS

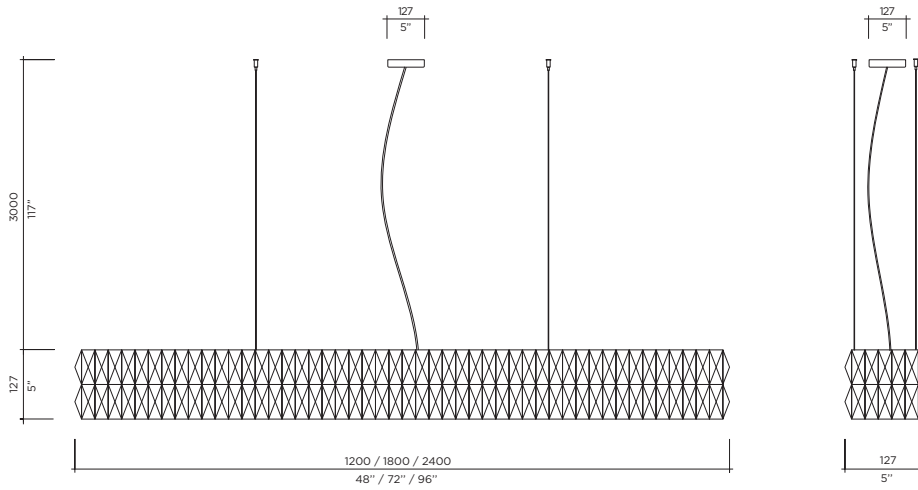



**Model** | **Gia Suspension**  
**Size** | 1200, 1800, 2400  
**Ref. #** | SM.07.271  
 MM.07.271  
 GM.07.271  
**Lamp** | G9 Bi-Pin Halogen (120V/220V)  
 5 x 25W (1200)  
 7 x 25W (1800)  
 10 x 25W (2400)  
 5 x 25W equivalent  
 7 x 25W equivalent  
 10 x 25W equivalent  

GIA LINEAR SPECS

	SM	MM	GM
Lbs	35	45	58
Kg	15,9	20,4	26,3



# CUBIE

Designer | Filipe Lisboa

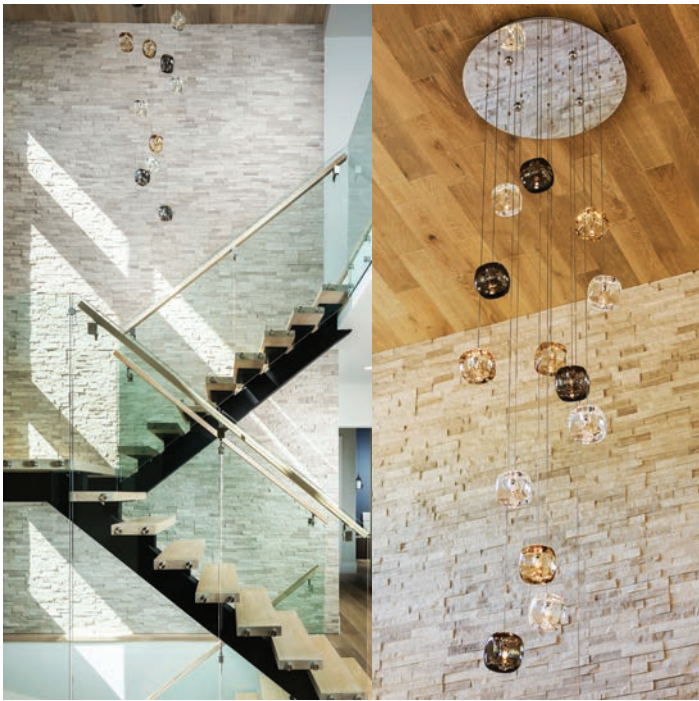

- Hand-molded crystal body
- Chrome metal canopy and metal details
- Unique cable suspension that does not require aircraft cables
- Custom designed clusters and drops are available
- LED option is available
- Dims from 100% - 15%
- ELV dimming

## OPTIONS



AMBER 11



CLEAR 12

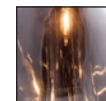

SMOKE 21



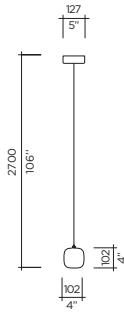

Model **Cubie Suspension**  
 Size 115  
 Ref. # MM.07.931.\_.\_  
 Lamp G4 Bi-Pin 12v - 120V/220V  
 1 x 10W (Standard lamp available)  
 G-4 Bi-Pin LED 2700K  
 120V/220V - 12V  
 1 x 2W (optional)

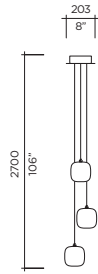

Model **Cubie Suspension**  
 Size 115  
 Ref. # 3MM.07.931.\_.\_  
 Lamp G4 Bi-Pin 12v - 120V/220V  
 3 x 10W (Standard lamp available)  
 G-4 Bi-Pin LED 2700K  
 120V/220V - 12V  
 3 x 2W (optional)

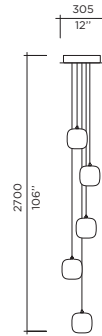

Model **Cubie Suspension**  
 Size 115  
 Ref. # 5MM.07.931.\_.\_  
 Lamp G4 Bi-Pin 12v - 120V/220V  
 5 x 10W (Standard lamp available)  
 G-4 Bi-Pin LED 2700K  
 120V/220V - 12V  
 5 x 2W (optional)

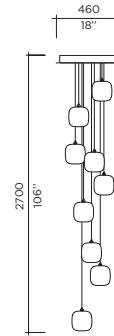

Model **Cubie Suspension**  
 Size 115  
 Ref. # 9MM.07.931.\_.\_  
 Lamp G4 Bi-Pin 12v - 120V/220V  
 9 x 10W (Standard lamp available)  
 G-4 Bi-Pin LED 2700K  
 120V/220V - 12V  
 9 x 2W (optional)

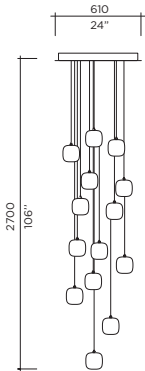

Model **Cubie Suspension**  
 Size 115  
 Ref. # 14MM.07.931.\_.\_  
 Lamp G4 Bi-Pin 12v - 120V/220V  
 14 x 10W (Standard lamp available)  
 G-4 Bi-Pin LED 2700K  
 120V/220V - 12V  
 14 x 2W (optional)

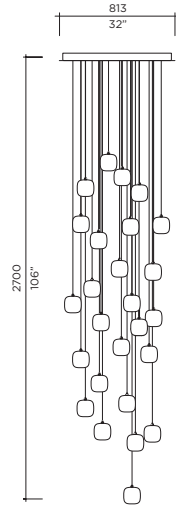

Model **Cubie Suspension**  
 Size 115  
 Ref. # 26MM.07.931.\_.\_  
 Lamp G4 Bi-Pin 12v - 120V/220V  
 26 x 10W (Standard lamp available)  
 G-4 Bi-Pin LED 2700K  
 120V/220V - 12V  
 26 x 2W (optional)

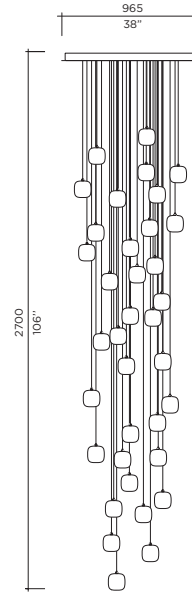

Model **Cubie Suspension**  
 Size 115  
 Ref. # 36MM.07.931.\_.\_  
 Lamp G4 Bi-Pin 12v - 120V/220V  
 36 x 10W (Standard lamp available)  
 G-4 Bi-Pin LED 2700K  
 120V/220V - 12V  
 36 x 2W (optional)



# GEMMA

Designer | Filipe Lisboa



Solid crystal body

Chrome metal canopy

Custom designed clusters and drops are available

LED option is available

Dims from 100% - 15%

ELV dimming



## OPTIONS



AMBER 11



CLEAR 12

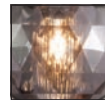

SMOKE 21

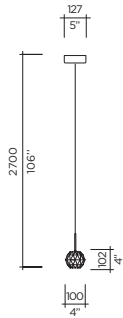

Model **Gemma Suspension**  
 Size 100  
 Ref. # MM.07.921.\_.\_  
 Lamp G4 Bi-Pin 12v - 120V/220V  
 1 x 10W (Standard lamp available)  
 G-4 Bi-Pin LED 2700K  
 120V/220V - 12V  
 1 x 2W (optional)

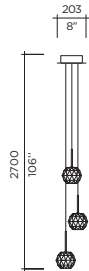

Model **Gemma Suspension**  
 Size 100  
 Ref. # 3MM.07.921.\_.\_  
 Lamp G4 Bi-Pin 12v - 120V/220V  
 3 x 10W (Standard lamp available)  
 G-4 Bi-Pin LED 2700K  
 120V/220V - 12V  
 3 x 2W (optional)

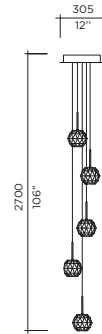

Model **Gemma Suspension**  
 Size 100  
 Ref. # 5MM.07.921.\_.\_  
 Lamp G4 Bi-Pin 12v - 120V/220V  
 5 x 10W (Standard lamp available)  
 G-4 Bi-Pin LED 2700K  
 120V/220V - 12V  
 5 x 2W (optional)

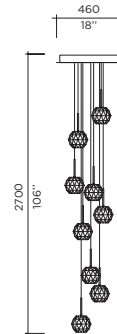

Model **Gemma Suspension**  
 Size 100  
 Ref. # 9MM.07.921.\_.\_  
 Lamp G4 Bi-Pin 12v - 120V/220V  
 9 x 10W (Standard lamp available)  
 G-4 Bi-Pin LED 2700K  
 120V/220V - 12V  
 9 x 2W (optional)

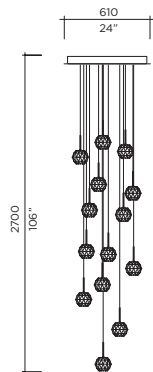

Model **Gemma Suspension**  
 Size 100  
 Ref. # 14MM.07.921.\_.\_  
 Lamp G4 Bi-Pin 12v - 120V/220V  
 14 x 10W (Standard lamp available)  
 G-4 Bi-Pin LED 2700K  
 120V/220V - 12V  
 14 x 2W (optional)

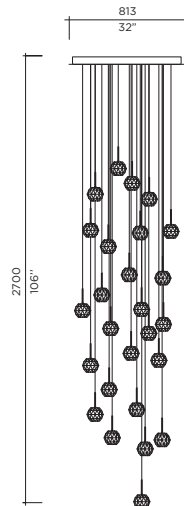

Model **Gemma Suspension**  
 Size 100  
 Ref. # 26MM.07.921.\_.\_  
 Lamp G4 Bi-Pin 12v - 120V/220V  
 26 x 10W (Standard lamp available)  
 G-4 Bi-Pin LED 2700K  
 120V/220V - 12V  
 26 x 2W (optional)

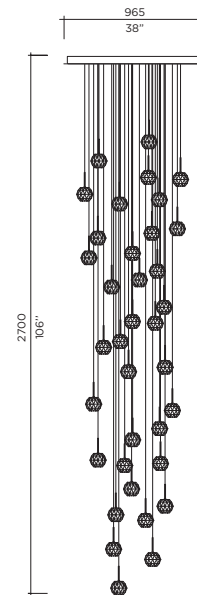

Model **Gemma Suspension**  
 Size 100  
 Ref. # 36MM.07.921.\_.\_  
 Lamp G4 Bi-Pin 12v - 120V/220V  
 36 x 10W (Standard lamp available)  
 G-4 Bi-Pin LED 2700K  
 120V/220V - 12V  
 36 x 2W (optional)



# ILU

Designer | VISO Design Studio



High-quality clear polycarbonate body  
Hand-painted Murano-style glass  
Chrome metal components  
LED option is available





INSERT OPTIONS



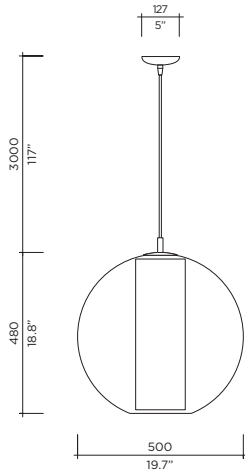

WHITE 10

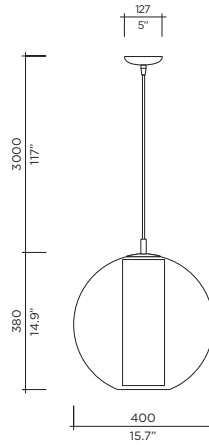

**Model** Ilu Suspension  
**Size** 500  
**Ref. #** GM.07.903\_ \_ \_ \_  
**Lamp** E26 / E27 (120V/220V)  
 1 x 60W max  
 (Incandescent)  
 1 x 60W equivalent  



**Model** Ilu Suspension  
**Size** 400  
**Ref. #** MM.07.902\_ \_ \_ \_  
**Lamp** E26 / E27 (120V/220V)  
 1 x 60W max  
 Incandescent  
 1 x 60W equivalent  

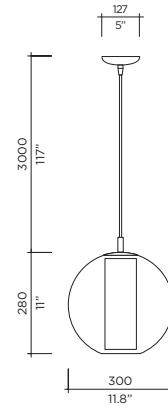

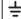
**Model** Ilu Suspension  
**Size** 300  
**Ref. #** SM.07.901\_ \_ \_ \_  
**Lamp** E26 / E27 (120V/220V)  
 1 x 40W max  
 Incandescent  
 1 x 40W equivalent  

	SM	MM	GM
Lbs	3	4	5
Kg	1.4	1.8	2.3



# THIN LED

Designer | Filipe Lisboa



Plated metal finishes are available

Dual dimming with 0-10V

ELV (reverse phase)

Colour temperature: 3000K

Custom canopies are available

Horizontal or vertical installation models

Custom metal finish components are available



## METALLIC FINISHES



SILVER 12





COPPER 22



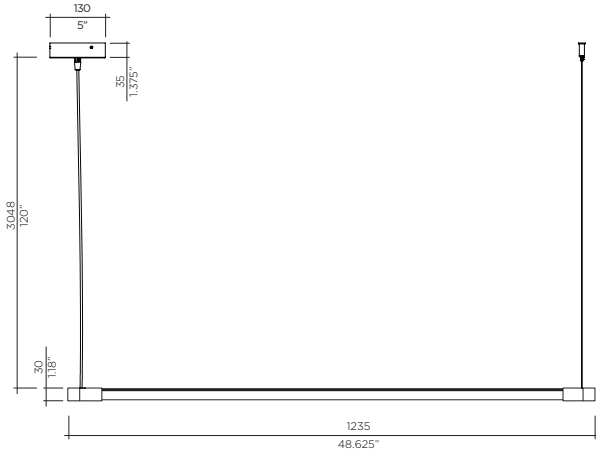

GOLD 24





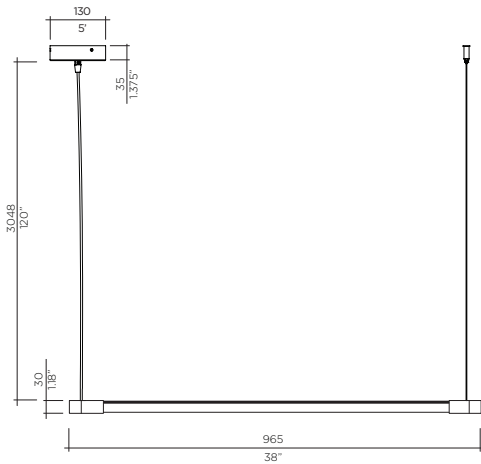

Model **Thin LED Suspension**  
 Size 1235  
 Ref. # SM.07.951\_\_\_L  
 Lamping 1 x 16W LED  
 3000K, 1280Lm  
 0-10V and ELV Dimming  

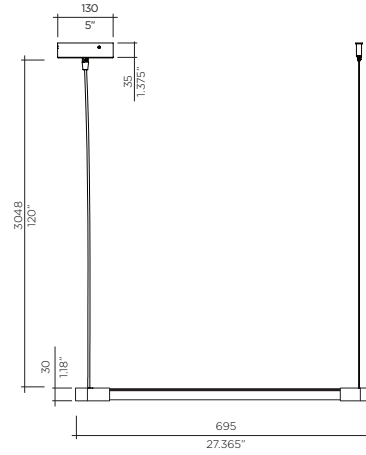

Model **Thin LED Suspension**  
 Size 965  
 Ref. # BM.07.950\_\_\_L  
 Lamping 1 x 12W LED  
 3000K, 960Lm  
 0-10V and ELV Dimming  





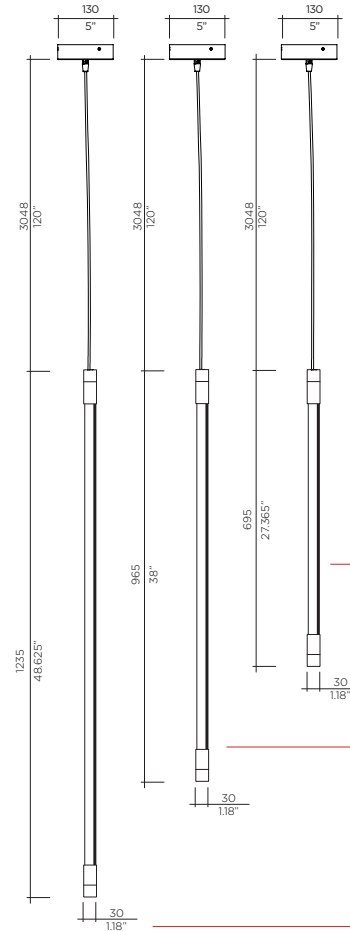

Model **Thin LED Suspension**  
 Size 695  
 Ref. # XBM.07.951\_\_\_L  
 Lamping 1 x 8W LED  
 3000K, 640Lm  
 0-10V and ELV Dimming  



	SM	BM	XBM
Lbs	1	1	1
Kg	.45	.45	.45



**VERTICAL CONFIGURATION**

Model **Thin LED Suspension**  
 Size 695  
 Ref. # XBM.07.950\_\_\_L  
 Lamping 1 x 8W LED  
 3000K, 640Lm  
 0-10V and ELV Dimming  

Model **Thin LED Suspension**  
 Size 965  
 Ref. # BM.07.950\_\_\_L  
 Lamping 1 x 12W LED  
 3000K, 960Lm  
 0-10V and ELV Dimming  

Model **Thin LED Suspension**  
 Size 1235  
 Ref. # SM.07.950\_\_\_L  
 Lamping 1 x 16W LED  
 3000K, 1280Lm  
 0-10V and ELV Dimming  

# BOLIO

Designer | VISO Design Studio



Half metallic, half transparent reflective globe

High-quality polycarbonate body

Metalized interior finish

Chrome metal canopy and components

Custom canopies are available

LED option is available

## REFLECTIVE FINISHES



SILVER 12



GOLD 24



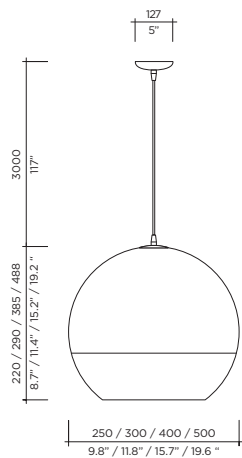

Model **Bolio Suspension**  
 Size 250, 300, 400, 500  
 Ref. # BM.07.120.\_\_  
 SM.07.120.\_\_  
 MM.07.121.\_\_  
 GM.07.122.\_\_  
 Lamp E26 / E27 (120V/220V)  
 1 x 40W max (250 only)  
 1 x 60W max (300 only)  
 1 x 75W max (400, 500)  
 Incandescent  
 1 x 40W equivalent  
 1 x 60W equivalent  
 1 x 75W equivalent



	BM	SM	MM	GM
Lbs	1	1	2	3
Kg	.5	.5	1	1.4



# GLOBO

Designer | Filipe Lisboa







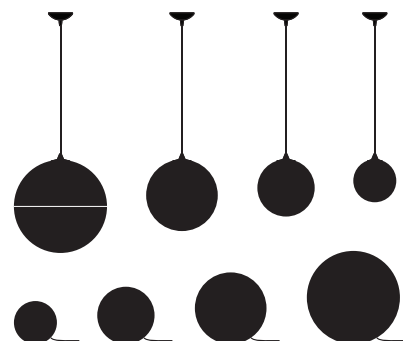

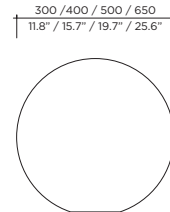
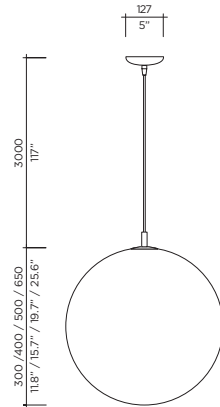
Frosted matte finish  
High-quality polycarbonate  
Interior seal ensures durability  
and evenly dispersed light  
Silver and grey metal components  
LED option is available

## OPTIONS

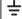



**Model** **Globo Suspension**  
**Size** 300, 400, 500, 650  
**Ref. #** SM.07.381\_ \_ \_  
 MM.07.382\_ \_ \_  
 GM.07.383\_ \_ \_  
 XGM.07.384\_ \_ \_  
**Lamp** E26 / E27 (120V/220V)  
 1 x 100W max (650, 500 only)  
 Incandescent  
 1 x 60W max (400, 300 only)  
 Incandescent  
 1 x 100W equivalent  
 1 x 60W equivalent  

**Model** **Globo Floor**  
**Size** 300, 400, 500, 650  
**Ref. #** SM.08.381\_ \_ \_  
 MM.08.382\_ \_ \_  
 GM.08.383\_ \_ \_  
 XGM.08.384\_ \_ \_  
**Lamp** E26 / E27 (120V/220V)  
 1 x 75W max (650 only)  
 Incandescent  
 1 x 60W max (500, 400, 300)  
 Incandescent  
 1 x 75W equivalent  
 1 x 60W equivalent  

	BM	SM	MM	GM
Lbs	4	8	9	14
Kg	1.8	3.6	4.1	6.4



# FORT KNOX

Designer | Filipe Lisboa

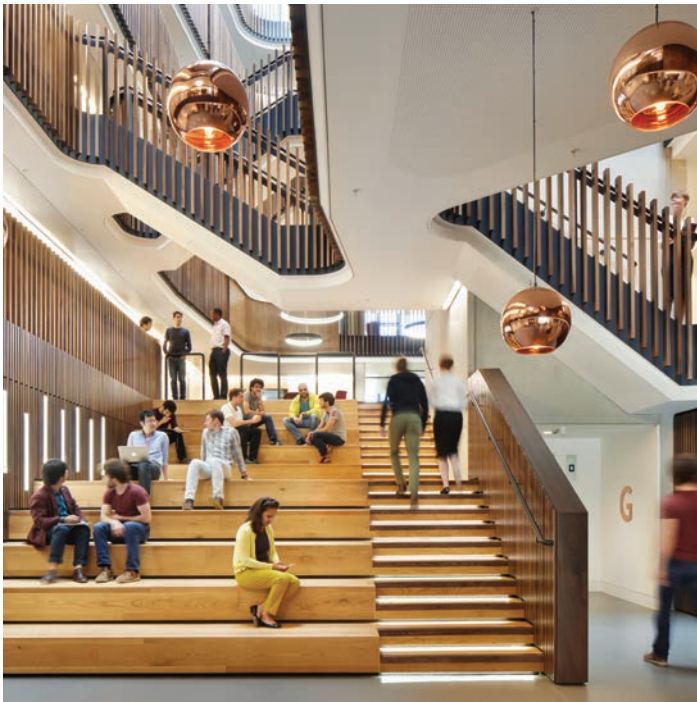

High-quality polycarbonate body for sizes SM, MM and GM

Spun metal body for size BM (baby) with white interior

Metalized interior and exterior finish

Black metal canopy

Custom designed clusters and drops are available

Includes black cable

LED option is available



## REFLECTIVE FINISHES



SILVER 12



SMOKE 21



COPPER 22



GOLD 24

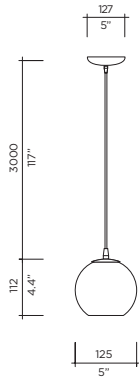

**Model** Fort Knox Suspension  
**Size** 125  
**Ref. #** BM.07.798\_\_  
**Lamp** G-4 Bi-Pin (12V-120V/220V)  
 1 x 20W max (G4 Halogen)  
 1 x 2W LED (G4)

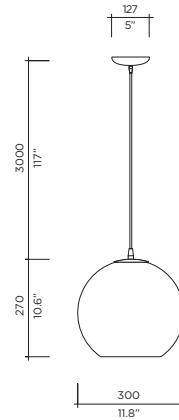

**Model** Fort Knox Suspension  
**Size** 300  
**Ref. #** SM.07.798\_\_  
**Lamp** E26 / E27 (120V/220V)  
 1 x 60W max (Incandescent)  
 1 x 60W equivalent

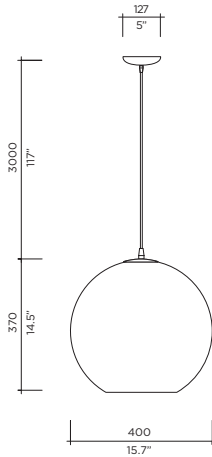

**Model** Fort Knox Suspension  
**Size** 400  
**Ref. #** MM.07.798\_\_  
**Lamp** E26 / E27 (120V/220V)  
 1 x 75W max (Incandescent)  
 1 x 75W equivalent

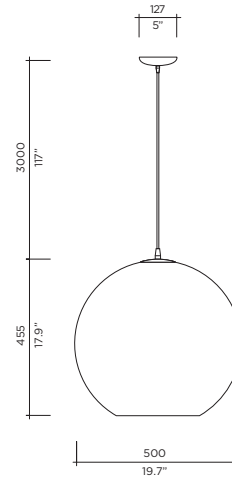

**Model** Fort Knox Suspension  
**Size** 500  
**Ref. #** GM.07.798\_\_  
**Lamp** E26 / E27 (120V/220V)  
 1 x 75W max (Incandescent)  
 1 x 75W equivalent

	BM	SM	MM	GM
Lbs	1	1	2	3
Kg	.45	.45	.9	1.4















VISO LIGHTING

388 CARLAW AVE. SUITE 207  
TORONTO ON M4M 2T4

VISOINC.COM | +1 416.461.8476 | INFO@VISOINC.COM

CANADA | USA | PORTUGAL | UAE

@visoinc

