



Ambrosia

Ciszak Dalmas

marset



Ambrosia A 60 left

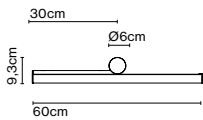

Ambrosia A 60 right

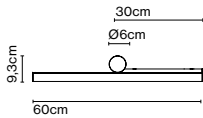

Disk accessory

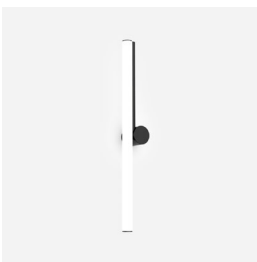

info@marset.com
www.marset.com

Ambrosia A 90 left

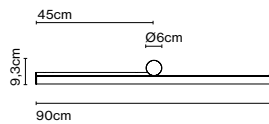

Ambrosia A 90 right

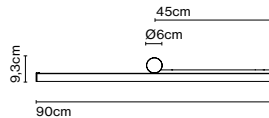

Ambrosia A 210

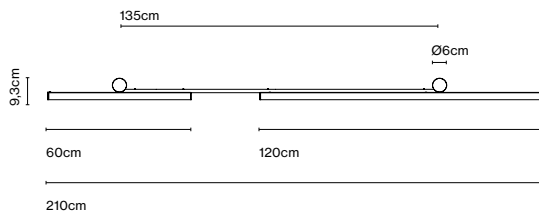

Power supply (RSC)

- Power supply 20W - 24V - Clase II - Triac
- Power supply 50W - 24V - Clase II - Triac
- Power supply 35W - 24V - Clase II - DALI
- Power supply 60W - 24V - Clase II - DALI

Aluminium structure. Methacrylate light tube.

- Black
- Matt Gold

Ambrosia A 60

- Light source Ambrosia 22K:
LED SMD 24Vdc 9,6W 2200K CRI80 1058lm
- Light source Ambrosia 27K:
LED SMD 24Vdc 9,6W 2700K CRI90 1014lm
- Light source Ambrosia 30K: LED SMD 24Vdc
9,6W 3000K CRI90 1028lm

Luminaire Ambrosia A 60:
(Power supply not included)

Ambrosia A 90

- Light source Ambrosia 22K:
LED SMD 24Vdc 14,4W 2200K CRI80 1587lm
- Light source Ambrosia 27K:
LED SMD 24Vdc 14,4W 2700K CRI90 1521lm
- Light source Ambrosia 30K:
LED SMD 24Vdc 14,4W 3000K CRI90 1692lm

Luminaire Ambrosia A 90:
(Power supply not included)

Ambrosia A 210

- Light source Ambrosia 22K:
LED SMD 24Vdc 28,8W 2200K CRI80 3174lm
- Luminaire Ambrosia 22K:
(Power supply not included) 2802lm

- Light source Ambrosia 27K:
LED SMD 24Vdc 28,8W 2700K CRI90 3042lm
- Luminaire Ambrosia 27K:
(Power supply not included) 2812lm

- Light source Ambrosia 30K:
LED SMD 24Vdc 28,8W 3000K CRI90 3384lm
- Luminaire Ambrosia 30K:
(Power supply not included) 2865lm

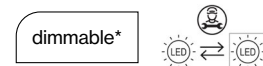

*It depends on the purchased power supply, Triac o DALI. 24V remote power supply to be ordered separately.

The starting point for the Ambrosia was to bring back the traditional Linestra lamp to update it and show that a technical, resolute design can also be poetic.